

# MIG TORCH ERGON BZ 24 SPRING PINS

MIG

CE

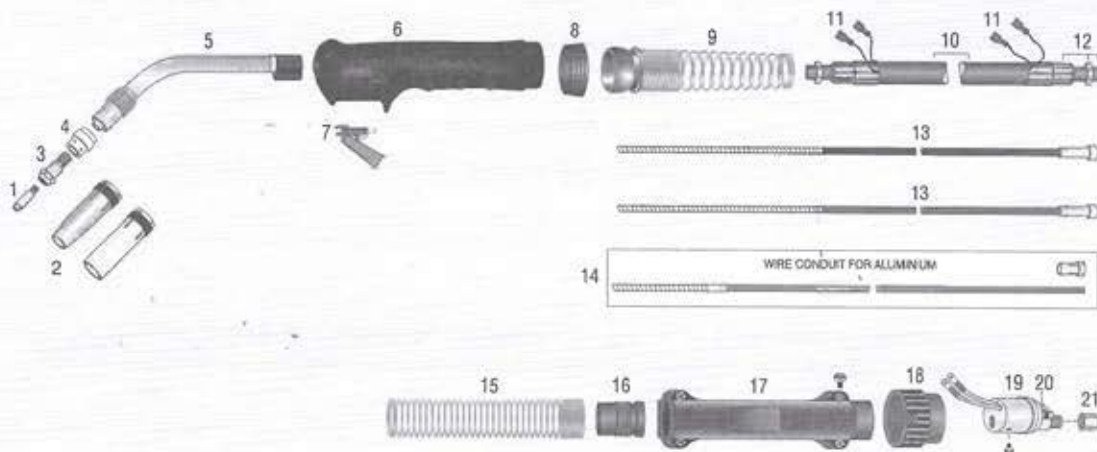





BZ 24

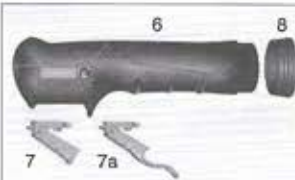

TENSION CLASS	POWER AT 60% CO <sub>2</sub> - MIX	COOLING	Part No	DESCRIPTION	€/ ea
L	250 A - 220 A	AIR	02.ER.24.3	TORCIA COMPLETA BZ 24 mt. 3	- COMPLETE MIG TORCH BZ 24 mt. 3
	250 A - 220 A		02.ER.24.4	TORCIA COMPLETA BZ 24 mt. 4	- COMPLETE MIG TORCH BZ 24 mt. 4
	250 A - 220 A		02.ER.24.5	TORCIA COMPLETA BZ 24 mt. 5	- COMPLETE MIG TORCH BZ 24 mt. 5

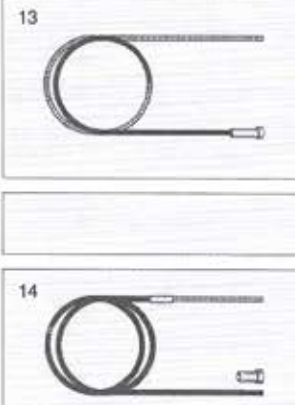
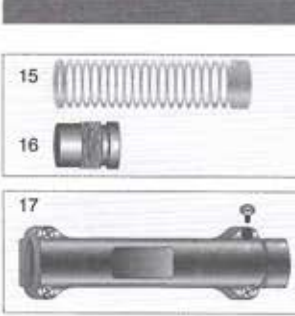
M6x28 STD	Part No	DESCRIPTION	PACK	€/ ea	M6x28 Special CUAG	Part No	DESCRIPTION	PACK	€/ ea
1	02.01.25.06	Punta M6x28 Ø 0,6 - Contact tip M6x28 Ø 0,6	100	0,68	1	02.01.25.08AG	Punta M6x28 Ø 0,8 - Contact tip M6x28 Ø 0,8	100	
	02.01.25.08	Punta M6x28 Ø 0,8 - Contact tip M6x28 Ø 0,8	100	0,68		02.01.25.09AG	Punta M6x28 Ø 0,9 - Contact tip M6x28 Ø 0,9	100	0,68
	02.01.25.09	Punta M6x28 Ø 0,9 - Contact tip M6x28 Ø 0,9	100	0,68		02.01.25.10AG	Punta M6x28 Ø 1,0 - Contact tip M6x28 Ø 1,0	100	0,68
	02.01.25.10	Punta M6x28 Ø 1,0 - Contact tip M6x28 Ø 1,0	100	0,68		02.01.25.12AG	Punta M6x28 Ø 1,2 - Contact tip M6x28 Ø 1,2	100	0,68
	02.01.25.12	Punta M6x28 Ø 1,2 - Contact tip M6x28 Ø 1,2	100	0,68		02.01.25.14AG	Punta M6x28 Ø 1,4 - Contact tip M6x28 Ø 1,4	100	0,68
	02.01.25.14	Punta M6x28 Ø 1,4 - Contact tip M6x28 Ø 1,4	100	0,68		02.01.25.16AG	Punta M6x28 Ø 1,6 - Contact tip M6x28 Ø 1,6	100	0,68
	02.01.25.16	Punta M6x28 Ø 1,6 - Contact tip M6x28 Ø 1,6	100	0,68					
M6x28 CUCRZR	Part No	DESCRIPTION	PACK	€/ ea	M6x28 Nickel Plated	Part No	DESCRIPTION	PACK	€/ ea
1	02.01.25.08H	Punta M6x28 Ø 0,8 - Contact tip M6x28 Ø 0,8	100	1,35	1	02.01.25.08N	Punta M6x28 Ø 0,8 - Contact tip M6x28 Ø 0,8	100	
	02.01.25.09H	Punta M6x28 Ø 0,9 - Contact tip M6x28 Ø 0,9	100	1,35		02.01.25.09N	Punta M6x28 Ø 0,9 - Contact tip M6x28 Ø 0,9	100	
	02.01.25.10H	Punta M6x28 Ø 1,0 - Contact tip M6x28 Ø 1,0	100	1,35		02.01.25.10N	Punta M6x28 Ø 1,0 - Contact tip M6x28 Ø 1,0	100	
	02.01.25.12H	Punta M6x28 Ø 1,2 - Contact tip M6x28 Ø 1,2	100	1,35		02.01.25.12N	Punta M6x28 Ø 1,2 - Contact tip M6x28 Ø 1,2	100	
	02.01.25.14H	Punta M6x28 Ø 1,4 - Contact tip M6x28 Ø 1,4	100	1,35		02.01.25.14N	Punta M6x28 Ø 1,4 - Contact tip M6x28 Ø 1,4	100	
	02.01.25.16H	Punta M6x28 Ø 1,6 - Contact tip M6x28 Ø 1,6	100	1,35		02.01.25.16N	Punta M6x28 Ø 1,6 - Contact tip M6x28 Ø 1,6	100	
M6x28 For Aluminium	Part No	DESCRIPTION	PACK	€/ ea	M6x28 Triangular Hole	Part No	DESCRIPTION	PACK	€/ ea
1	02.01.25.08AL	Punta M6x28 Ø 0,8 - Contact tip M6x28 Ø 0,8	100	0,72	1	02.01.25.10T	Punta M6x28 Ø 1,0 - Contact tip M6x28 Ø 1,0	100	
	02.01.25.10AL	Punta M6x28 Ø 1,0 - Contact tip M6x28 Ø 1,0	100	0,72		02.01.25.12T	Punta M6x28 Ø 1,2 - Contact tip M6x28 Ø 1,2	100	
	02.01.25.12AL	Punta M6x28 Ø 1,2 - Contact tip M6x28 Ø 1,2	100	0,72		02.01.25.14T	Punta M6x28 Ø 1,4 - Contact tip M6x28 Ø 1,4	100	
	02.01.25.16AL	Punta M6x28 Ø 1,6 - Contact tip M6x28 Ø 1,6	100	0,72		02.01.25.16T	Punta M6x28 Ø 1,6 - Contact tip M6x28 Ø 1,6	100	

ITEM	Part No	DESCRIPTION	ORIGINAL REF.	PACK	€/ ea
2	02.02.24 CO	Ugello conico Ø 12,5	- Adjustable conical nozzle Ø 12,5	10	
	02.02.24 CL	Ugello cilindrico Ø 17	- Adjustable cylindrical nozzle Ø 17	10	
	02.02.24.10	Ugello conico Ø 10	- Adjustable conical nozzle Ø 10	10	
3	02.03.24.M6	Supporto punta	- Tip holder M6	50	
4	02.05.24	Diffusore gas	- Gas diffuser	50	
	02.05.24K	Diffusore gas ceramica	- Ceramic gas diffuser	10	
	02.05.24M	Diffusore gas special marrone	- Gas diffuser special brown	10	
5	02.06.24	Lancia	- Conductor tube	1	
	02.10.15	Corpo torcia PVC	- PVC torch body	1	

ITEM	Part No	DESCRIPTION	ORIGINAL REF. PACK	€/ea
	02.08.ER.16	Impugnatura ergonomica Ø 16 mm. con viti	- Ergonomic Handle with screw Ø 16 mm.	
	02.08.ER.01	Vite per impugnatura	- Screw for ergonomic handle	
	02.08.ER.02	Ghiera	- Housing for handle	
	02.09.A.BZ	Pulsante interruttore STD	- Trigger std	
	02.09.ER	Pulsante interruttore lungo	- Long trigger	
	02.09.ER.3	Pulsante interruttore lungo con 3 contatti	- Long trigger with switch 3 contact	
	02.144.ER	Supporto snodo anteriore con molla	- Joint with spring	
	02.20.25	Cavo coassiale 25 mmq - 250A	- Coaxial cable 25 mmq - 250A - per mt.	
	02.20.25.3	Cavo coassiale assemblato mt.3	- Assembled cable mt.3	
	02.20.25.4	Cavo coassiale assemblato mt.4	- Assembled cable mt.4	
	02.20.25.5	Cavo coassiale assemblato mt.5	- Assembled cable mt.5	
	VA.A22T/P	Faston femmina	- Faston female	
	VA.B18.20	Manicotto serraggio cavi	- Sleeve	
	02.06.15.01	Dado Ø 10x1 mm.	- Nut Ø 10x1 mm.	
	VA.RC.15E	Raccordo con cavo coassiale	- Coax-cable fitting	
	01.244M	Faston interruttore	- Faston for switch	
	02.04.T3	Guaina guidafile blu Ø 0,6 1,0 mt.3	- Liner Ø 0,6 - 1,0 Blue mt.3	
	02.04.T4	Guaina guidafile blu Ø 0,6 1,0 mt.4	- Liner Ø 0,6 - 1,0 Blue mt.4	
	02.04.T5	Guaina guidafile blu Ø 0,6 1,0 mt.5	- Liner Ø 0,6 - 1,0 Blue mt.5	
	02.04.R3	Guaina guidafile rossa Ø 1,0 - 1,2 mt.3	- Liner Ø 1,0 - 1,2 Red mt.3	
	02.04.R4	Guaina guidafile rossa Ø 1,0 - 1,2 mt.4	- Liner Ø 1,0 - 1,2 Red mt.4	
	02.04.R5	Guaina guidafile rossa Ø 1,0 - 1,2 mt.5	- Liner Ø 1,0 - 1,2 Red mt.5	
	02.30.08	O-Ring	- O-Ring	
	02.04.AL	Guaina guidafile per alluminio mt. 4,5	- Liner for Aluminium mt. 4,5	
	02.04.ALT	Capocorda	- Nut for liner for Aluminium	
	02.04.AL5	Guaina guidafile per alluminio mt. 5,5	- Liner for Aluminium mt. 5,5	
<b>FOR OTHER LINERS FOR ALUMINIUM LOOK AT PAGE 77</b>				
	02.30.01	Mollone posteriore	- Cable support spring	
	02.30.02	Manicotto per mollone	- Cable protector grommet	
	02.30.03	Scatola posteriore	- Connector case	
	02.30.04	Ghiera	- Nut	
	02.30.05	Corpo torcia posteriore spinette mobili	- EURO connector - SPRING PINS	
	13.30.08	Corpo torcia posteriore SAF spinette mobili	- EURO connector SAF® - SPRING PINS	
	02.30.08	O-RING	- O-RING	
	VA.A22/P	Faston maschio	- Faston male	
	02.30.06	Dado	- Liner nut	
	13.30.08.1	Spinetta maschio mobile	- Spring pin	