

MIG TORCH ERGON BZ 25 SPRING PINS

MIG

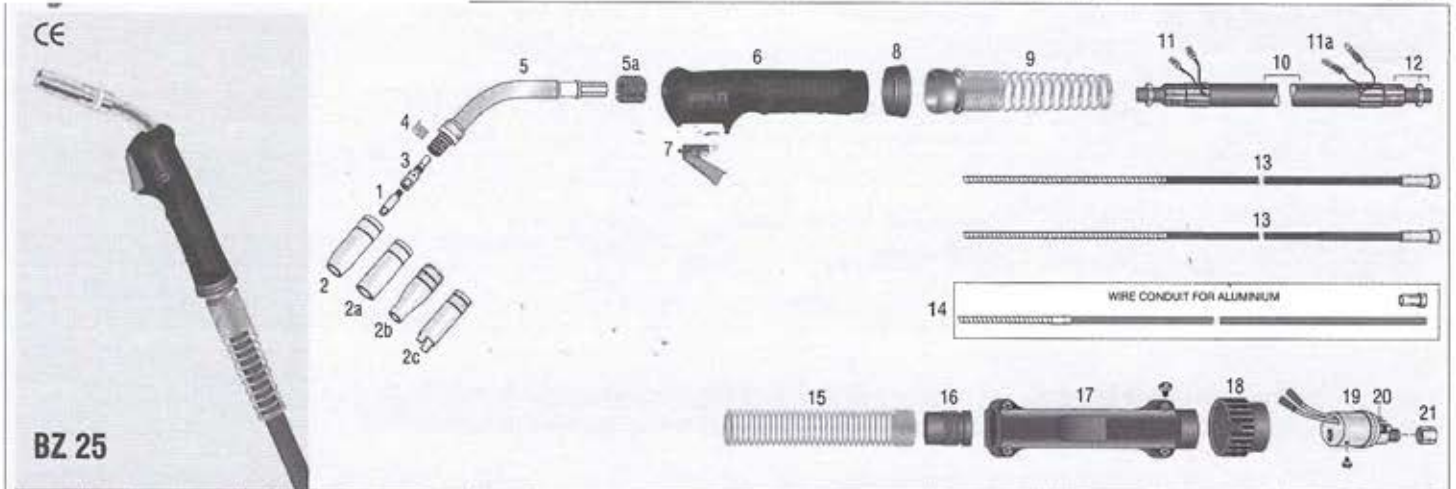

BZ 25

TENSION CLASS	POWER AT 60% CO ₂ - MIX	COOLING	Part No	DESCRIPTION
L	230 A - 200 A	AIR	02.ER.25.3	TORCIA COMPLETA BZ 25 mt. 3 - COMPLETE MIG TORCH BZ 25 mt. 3
	230 A - 200 A		02.ER.25.4	TORCIA COMPLETA BZ 25 mt. 4 - COMPLETE MIG TORCH BZ 25 mt. 4
	230 A - 200 A		02.ER.25.5	TORCIA COMPLETA BZ 25 mt. 5 - COMPLETE MIG TORCH BZ 25 mt. 5

M6x28 STD	Part No	DESCRIPTION	PACK
1	02.01.25.06	Punta M6x28 Ø 0,6 - Contact tip M6x28 Ø 0,6	100
	02.01.25.08	Punta M6x28 Ø 0,8 - Contact tip M6x28 Ø 0,8	100
	02.01.25.09	Punta M6x28 Ø 0,9 - Contact tip M6x28 Ø 0,9	100
	02.01.25.10	Punta M6x28 Ø 1,0 - Contact tip M6x28 Ø 1,0	100
	02.01.25.12	Punta M6x28 Ø 1,2 - Contact tip M6x28 Ø 1,2	100
	02.01.25.14	Punta M6x28 Ø 1,4 - Contact tip M6x28 Ø 1,4	100
	02.01.25.16	Punta M6x28 Ø 1,6 - Contact tip M6x28 Ø 1,6	100

M6x28 Special CUAG	Part No	DESCRIPTION	PACK
1	02.01.25.08AG	Punta M6x28 Ø 0,8 - Contact tip M6x28 Ø 0,8	100
	02.01.25.09AG	Punta M6x28 Ø 0,9 - Contact tip M6x28 Ø 0,9	100
	02.01.25.10AG	Punta M6x28 Ø 1,0 - Contact tip M6x28 Ø 1,0	100
	02.01.25.12AG	Punta M6x28 Ø 1,2 - Contact tip M6x28 Ø 1,2	100
	02.01.25.14AG	Punta M6x28 Ø 1,4 - Contact tip M6x28 Ø 1,4	100
	02.01.25.16AG	Punta M6x28 Ø 1,6 - Contact tip M6x28 Ø 1,6	100







M6x28 CUCRZR	Part No	DESCRIPTION	PACK
1	02.01.25.08H	Punta M6x28 Ø 0,8 - Contact tip M6x28 Ø 0,8	100
	02.01.25.09H	Punta M6x28 Ø 0,9 - Contact tip M6x28 Ø 0,9	100
	02.01.25.10H	Punta M6x28 Ø 1,0 - Contact tip M6x28 Ø 1,0	100
	02.01.25.12H	Punta M6x28 Ø 1,2 - Contact tip M6x28 Ø 1,2	100
	02.01.25.14H	Punta M6x28 Ø 1,4 - Contact tip M6x28 Ø 1,4	100
	02.01.25.16H	Punta M6x28 Ø 1,6 - Contact tip M6x28 Ø 1,6	100

M6x28 Nickel Plated	Part No	DESCRIPTION	PACK
1	02.01.25.08N	Punta M6x28 Ø 0,8 - Contact tip M6x28 Ø 0,8	100
	02.01.25.09N	Punta M6x28 Ø 0,9 - Contact tip M6x28 Ø 0,9	100
	02.01.25.10N	Punta M6x28 Ø 1,0 - Contact tip M6x28 Ø 1,0	100
	02.01.25.12N	Punta M6x28 Ø 1,2 - Contact tip M6x28 Ø 1,2	100
	02.01.25.14N	Punta M6x28 Ø 1,4 - Contact tip M6x28 Ø 1,4	100
	02.01.25.16N	Punta M6x28 Ø 1,6 - Contact tip M6x28 Ø 1,6	100

M6x28 For Aluminium	Part No	DESCRIPTION	PACK
1	02.01.25.08AL	Punta M6x28 Ø 0,8 - Contact tip M6x28 Ø 0,8	100
	02.01.25.10AL	Punta M6x28 Ø 1,0 - Contact tip M6x28 Ø 1,0	100
	02.01.25.12AL	Punta M6x28 Ø 1,2 - Contact tip M6x28 Ø 1,2	100
	02.01.25.16AL	Punta M6x28 Ø 1,6 - Contact tip M6x28 Ø 1,6	100

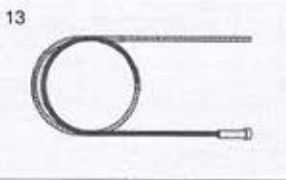
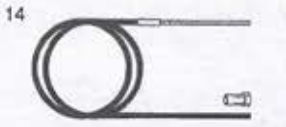
M6x28 Triangular Hole	Part No	DESCRIPTION	PACK
1	02.01.25.10T	Punta M6x28 Ø 1,0 - Contact tip M6x28 Ø 1,0	100
	02.01.25.12T	Punta M6x28 Ø 1,2 - Contact tip M6x28 Ø 1,2	100
	02.01.25.14T	Punta M6x28 Ø 1,4 - Contact tip M6x28 Ø 1,4	100
	02.01.25.16T	Punta M6x28 Ø 1,6 - Contact tip M6x28 Ø 1,6	100

ITEM	Part No	DESCRIPTION	ORIGINAL REF.	PACK
2	02.02.25C0	Ugello conico Ø 15 STD	- Adjustable conical nozzle Ø 15 STD	10
	02.02.25CL	Ugello cilindrico Ø 18	- Adjustable cylindrical nozzle Ø 18	10
	02.02.25CC.11	Ugello conico Ø 11,5	- Adjustable conical nozzle Ø 11,5	10
	02.02.25B0.11	Ugello a bottiglia Ø 11	- Adjustable tapered nozzle Ø 11	10
	02.02.25B0.14	Ugello a bottiglia Ø 14	- Adjustable tapered nozzle Ø 14	10
	02.02.25PT	Ugello per puntatura	- Adjustable spot nozzle	10
	3	02.05.25	Diffusore Gas STD	- Gas diffuser standard
02.05.25.L		Diffusore Gas L=37 mm.	- Gas diffuser L=37 mm.	10
02.05.25.M8		Diffusore Gas M8x35 mm.	- Gas diffuser M8x35 mm.	10
4	02.05.25.01	Molla	- Spring	50
5	02.06.25	Lancia	- Conductor tube	1
	02.10.15	Corpo torcia PVC	- PVC torch body	1
5b	02.06.25FLX	Lancia flessibile ad INNESTO	- Flexible swan neck	1
	02.06.15.02	Dado lungo Ø M10x1	- Long nut Ø M10x1	1

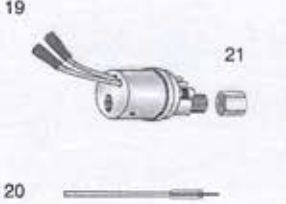
ITEM	Part No	DESCRIPTION	ORIGINAL REF.	PACK
	02.08.ER.16	Impugnatura ergonomica Ø 16 mm.	- Ergonomica Handle w/o screw	
	02.08.ER.01	Vite per impugnatura	- Screw for ergonomic handle	
	02.08.ER.02	Ghiera	- Housing for handle	
	02.09.A.BZ	Pulsante interruttore std	- Trigger std	
	02.09.ER	Pulsante interruttore lungo	- Long trigger	
	02.09.ER.3	Pulsante interruttore lungo con micro 3C	- Long trigger with switch 3 contacts	
	02.144.ER	Supporto snodo anteriore più molla	- Joint with spring	
	02.144.ERH	Supporto snodo	- Joint	
	02.144.M	Molla	- Spring	
	02.20.25	Cavo coassiale 25 mmq - 250A	- Coaxial cable 25 mmq - 250A - per mt.	
	02.20.25.3	Cavo coassiale assemblato mt.3	- Assembled cable mt.3	
	02.20.25.4	Cavo coassiale assemblato mt.4	- Assembled cable mt.4	
	02.20.25.5	Cavo coassiale assemblato mt.5	- Assembled cable mt.5	
	01.244M	Faston per interruttore	- Faston for switch	
	VA.A96/P	Faston maschio cilindrico	- Faston male	
	VA.B1820	Manicotto serraggio cavi	- Sleeve	
	02.06.15.01	Dado Ø 10x1 mm.	- Nut Ø 10x1 mm.	
	VA.RC15E	Raccordo con cavo coassiale	- Coax-cable fitting	
		02.04.T3	Guaina guidafile blu Ø 0,6 - 1,0 mt.3	- Liner Ø 0,6 - 1,0 Blue mt.3
02.04.T4		Guaina guidafile blu Ø 0,6 - 1,0 mt.4	- Liner Ø 0,6 - 1,0 Blue mt.4	
02.04.T5		Guaina guidafile blu Ø 0,6 - 1,0 mt.5	- Liner Ø 0,6 - 1,0 Blue mt.5	
02.04.R3		Guaina guidafile rossa Ø 1,0 - 1,2 mt.3	- Liner Ø 1,0 - 1,2 Red mt.3	
02.04.R4		Guaina guidafile rossa Ø 1,0 - 1,2 mt.4	- Liner Ø 1,0 - 1,2 Red mt.4	
02.04.R5		Guaina guidafile rossa Ø 1,0 - 1,2 mt.5	- Liner Ø 1,0 - 1,2 Red mt.5	
	02.30.08	O-Ring	- O-Ring	
	02.04.AL	Guaina guidafile per alluminio mt. 4,5	- Liner for Aluminium mt. 4,5	
	02.04.ALT	Capocorda	- Nut for liner for Aluminium	
	02.04.AL5	Guaina guidafile per alluminio mt. 5,5	- Liner for Aluminium mt. 5,5	
FOR OTHER LINERS FOR ALUMINIUM LOOK AT PAGE 81				
	02.30.01	Mollone posteriore	- Cable support spring	
	02.30.02	Manicotto per mollone	- Cable protector grommet	
	02.30.03	Scatola posteriore	- Connector case	
	02.30.091	Vite per scatola posteriore	- Screw	
	02.30.04	Ghiera	- Nut	
	02.30.05	Corpo torcia posteriore spinette mobili	- EURO connector - SPRING PINS	
	13.30.08	Corpo torcia posteriore SAF spinette mobili	- EURO connector SAF® - SPRING PINS	
	02.30.08	O-RING	- O-RING	
	VA.A69/P	Faston femmina cilindrico	- Faston female	
	02.30.06	Dado	- Liner nut	
	13.30.08.1	Spinetta maschio mobile	- Spring pin	